

7 U H Q F K 0 2 6 % D U U L H U 6 F K R W W N \ 5 H

Features

Applications

Maximum ratings and electrical characteristics (T_J = 25°C unless otherwise noted)

qR0 ĐpR W K F K0H U

3 X O V H W H V W 3 X O V H Z L G W K G X W \ F \ F O H
3 X O V H W H V W 3 X O P W H Z L G W K 0

RATINGS AND CHARACTERISTICS CURVES

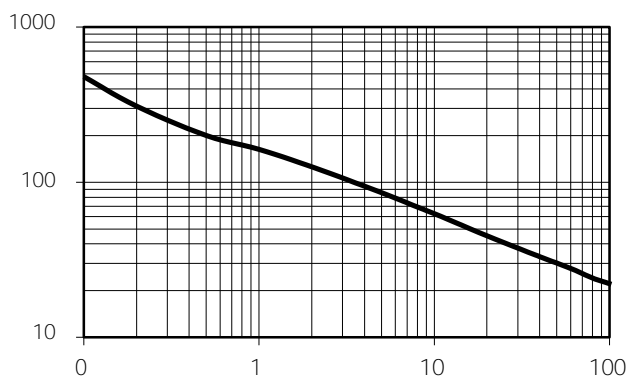
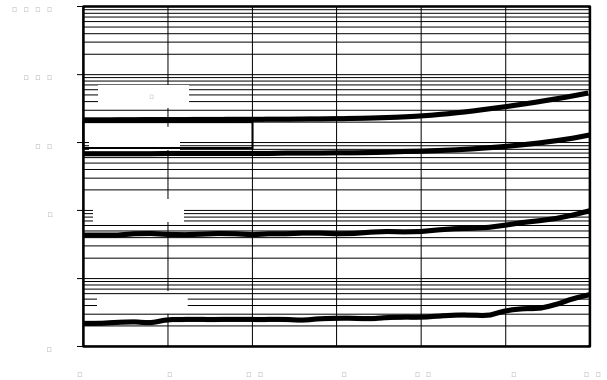
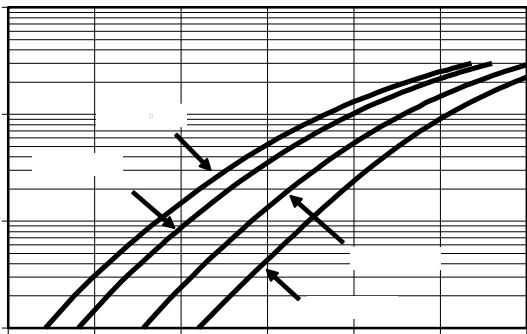
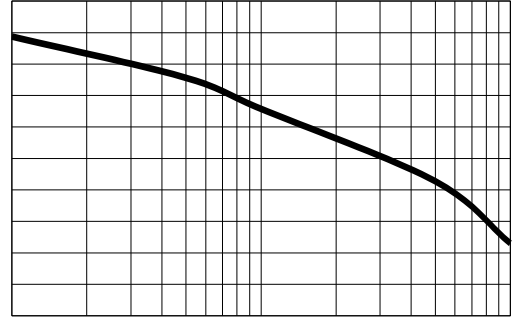
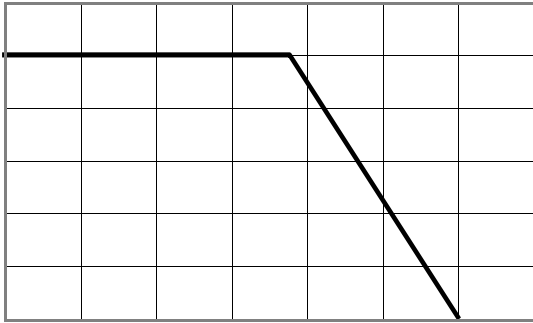

A

PACKAGE OUTLINE DIMENSIONS

SMP6

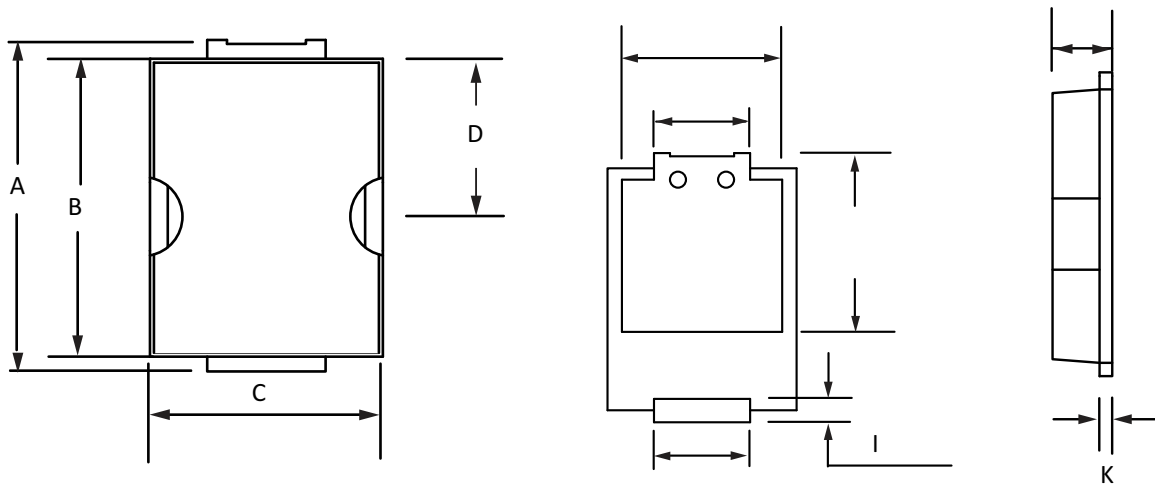

SMP6 mechanical data

SMP6 Suggested Pad Layout

